

School Day Logistics

Arrival

On arrival to school, students should enter using the pedestrian gate identified and follow colour coded prompts to their designated year area, these will be signposted, and markers will be on the floor – see attached map for details. Students being arriving in vehicles at the turning circle should be dropped off at their designated year group point from which they make their way to their year group area.

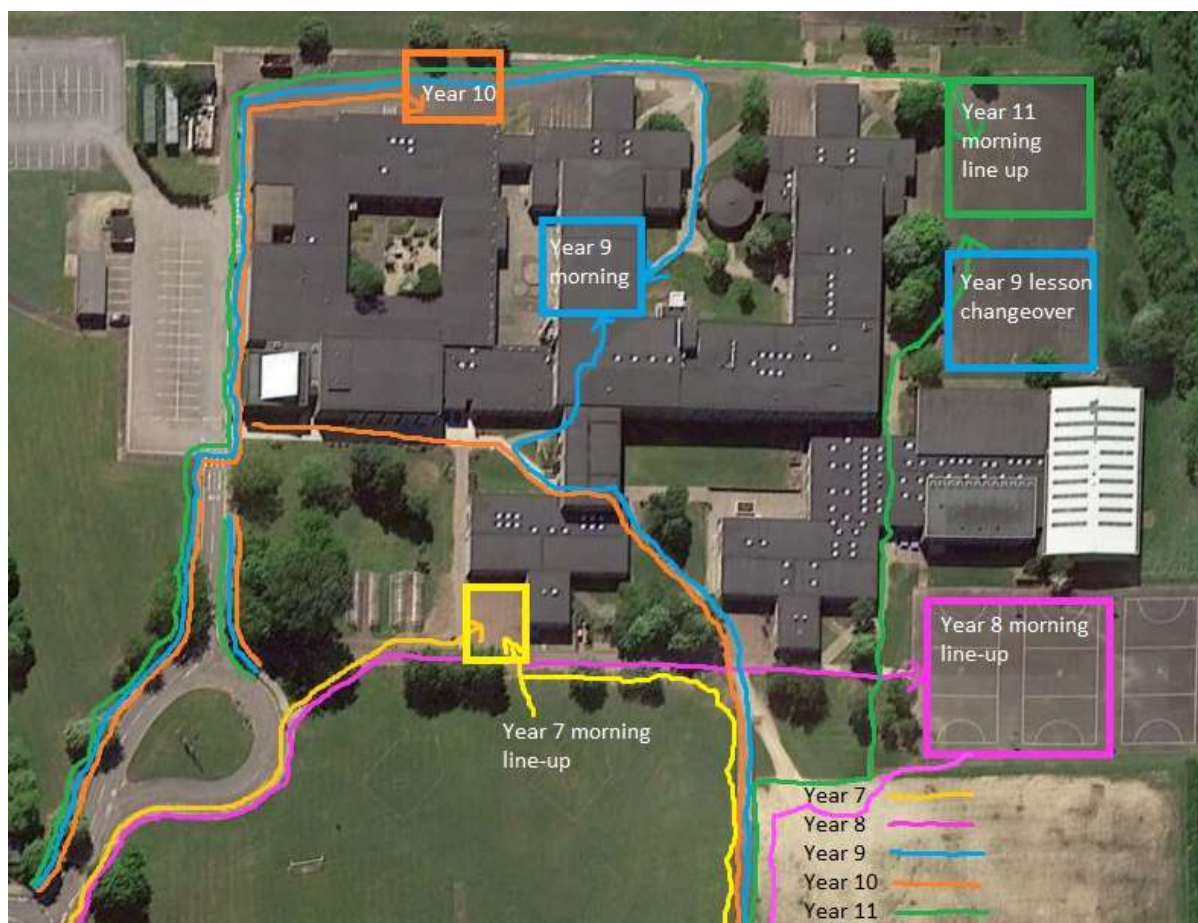

Break and lunchtime

- The school will be divided up into specific areas where students will be allowed to go during break and lunchtime – this is shown on the map on page 2. There may be some variation at lunchtime but toilet provision will remain the same.

Break

Year 7 Durham dining hall – using toilets in dining hall
Year 8 Main hall – using toilets in Student Support
Year 9 Morning line-up area – using toilets outside Raby – food available in the roundhouse
Year 10 Area outside Lambton – using toilets outside Lambton – food available in the Drama Hall
Year 11 Brancepeth dining hall – using toilets in PE changing rooms and Brancepeth

- Outside fields will be marked with specific areas that students are allowed to access at break and lunchtime. These will be adjacent to the space identified above

Lunch

Year 7s and 9s will access lunch earlier to try to vacate dining rooms as early as possible.

Durham Dining Hall rota:

12.10 - year 7s taken to dining hall by subject teachers

12.30 - year 8s taken to dining hall by subject teachers

Brancepeth Dining Hall rota:

12.10 - year 9s taken to Brancepeth dining hall by subject teachers

12.30 - year 11s taken to Brancepeth dining hall by subject teachers

Drama Hall:

12.30 - year 10s taken to Drama Hall by subject teachers

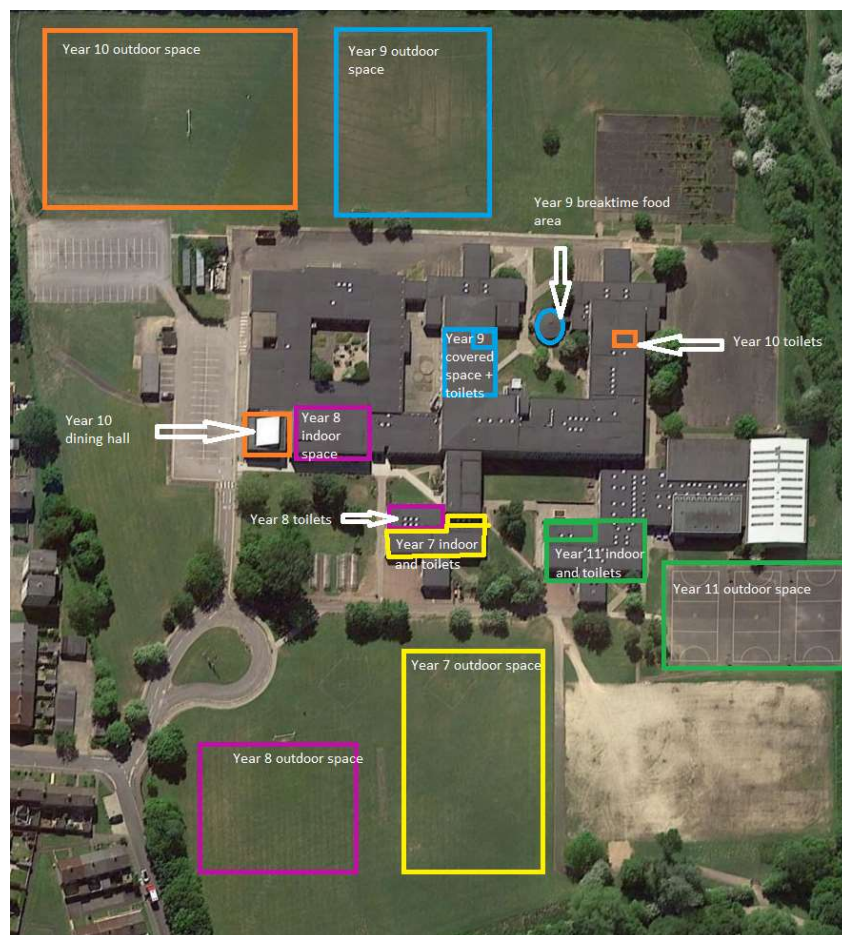

End of the day

3.05pm Year 7s escorted by staff to the bus turning circle

3.10pm Year 8s are escorted to the main gate by staff – students should leave by main gate

3.10pm Year 9s are escorted to side gate by staff – all students should leave through side gate

3.15pm Year 10s are escorted to side gate by staff – all students should leave through side gate

3.15pm Year 11s are escorted to the main gate by staff – students should leave by main gate